



## Toyota Camry 2007-2011

Visit [MetraOnline.com](http://MetraOnline.com) for more detailed information about the product and up-to-date vehicle specific applications

### KIT FEATURES

- DIN radio provision with pocket
- ISO DIN radio provision with pocket
- ISO DDIN radio provision

### KIT COMPONENTS

- A) Radio housing • B) Radio housing brackets • C) ISO brackets • D) ISO DDIN brackets • E) ISO trim plate • F) ISO DDIN trim plate • G) Pocket  
 • H) (4) #8 x 3/8" Phillips screws • I) (4) #4 x 1/4" Phillips screws

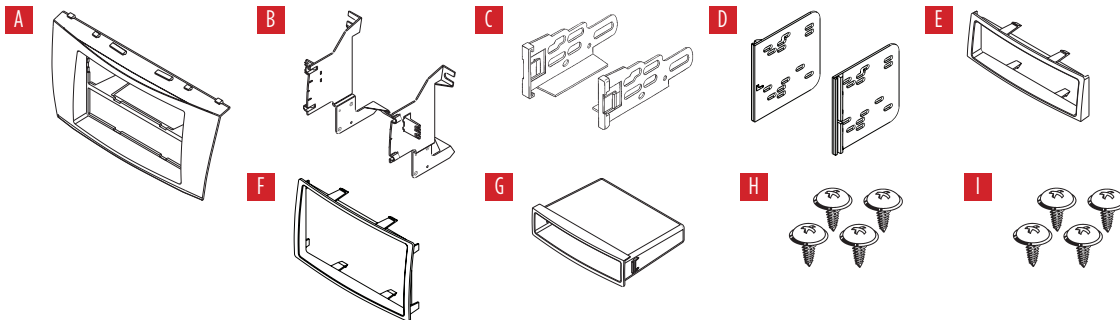

### TABLE OF CONTENTS

Dash Disassembly .....	2-3
Kit Assembly	
–DIN radio provision with pocket .....	4
–ISO DIN radio provision with pocket .....	5
–ISO DDIN radio provision.....	6

### WIRING & ANTENNA CONNECTIONS (sold separately)

Wiring Harness: 70-1761 • TYTO-01  
 Antenna Adapter: Not required

### TOOLS REQUIRED

- Panel removal tool • Phillips screwdriver
- 10mm socket wrench

**Attention!** Let the vehicle sit with the key out of the ignition for a few minutes before removing the factory radio. When testing the aftermarket equipment, ensure that all factory equipment is connected before cycling the key to ignition.

## DASH DISASSEMBLY

1. Turn the shift knob counterclockwise to remove.
2. Unclip and remove (1) trim panel from each side of the pocket below the radio/climate control assembly. (2 panels total) (Figure A)
3. Unclip and remove the shift knob trim panel. (Figure B)
4. Unclip and remove the top of the center console including the cup holders. (Figure B)
5. Remove (1) Phillips screw from each side of pocket below the radio/climate control assembly (2 screws total). (Figure C)
6. Unclip and remove the pocket. (Figure C)

*Continued on next page*

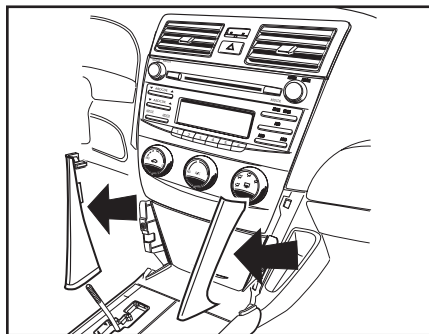

(Figure A)

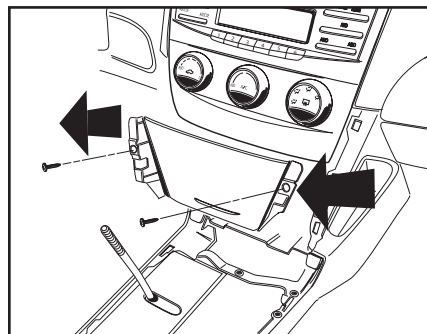

(Figure C)

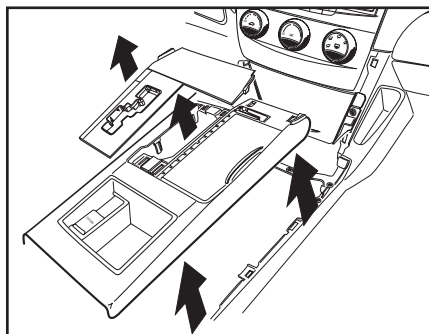

(Figure B)

## DASH DISASSEMBLY (CONT.)

- Unclip and remove the A/C vents above the radio. (Take care not to scratch the dash panel). (Figure D)
- Remove (2) 10mm bolts above the radio (behind the A/C vents) and (2) 10mm bolts below the climate controls (behind pocket) then unplug and remove the radio/climate control assembly. (Figure E)
- Remove the (10) Phillips screws securing the brackets to the radio/climate control assembly and separate the radio from the climate controls. (Retain climate controls and screws for use during kit assembly). (Figure F)
- Unscrew and remove the (2) Clips from the back of the factory radio. (Retain clips for use during kit assembly). (Figure F)

*Continue to Kit Assembly*

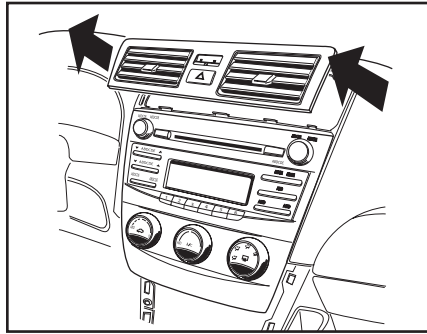

(Figure D)

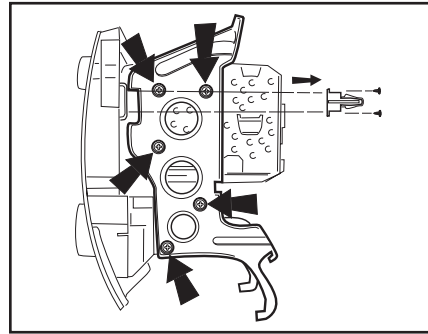

(Figure F)

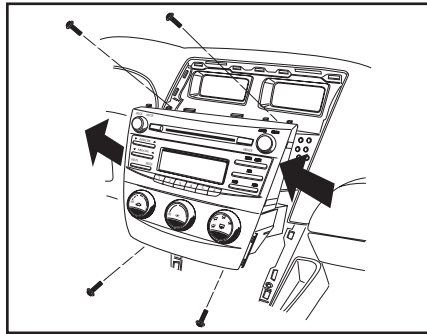

(Figure E)

## KIT ASSEMBLY

### DIN radio provision with pocket

1. Remove the metal DIN sleeve from the aftermarket radio.
2. Slide the sleeve into the **radio housing** and secure by bending the metal locking tabs down. (Figure A)
3. Slide the radio into the sleeve until it clicks in. (Figure B)
4. Snap the **pocket** into the **radio housing**. (Figure B)
5. Align the small legs on the bottom of the **radio housing** with the slots in the top of the climate control, then slide the climate control sideways to engage together. (Figure C)

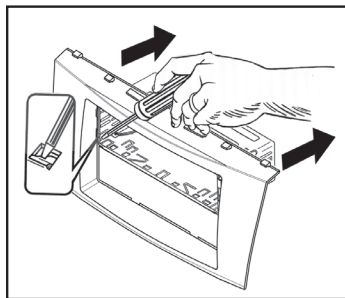

(Figure A)

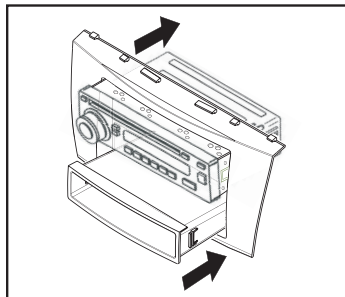

(Figure B)

6. Secure the **radio housing brackets** to the **radio housing** using the (4) #8 x 3/8 Phillips screws provided. (Figure D)
7. Secure the **radio housing brackets** to the climate control using the factory screws. (Figure D)
8. Secure the (2) clips removed in Dash Disassembly to the **radio housing brackets** using (4) #8 x 3/8 Phillips screws provided. (Figure D)
9. Locate the factory wiring harness and antenna connector in the dash. Metra recommends using the proper mating adapter from Metra or AXXESS. Test the radio for proper operation.
10. Slide the radio assembly into the dash, then secure using the factory screws.
11. Reassemble the dash in reverse order of disassembly to complete the installation.

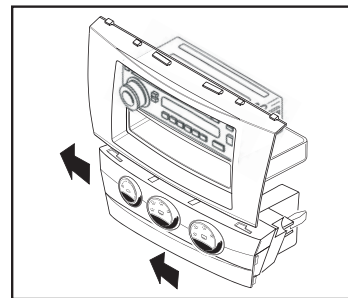

(Figure C)

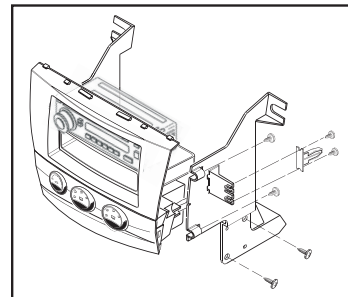

(Figure D)

## KIT ASSEMBLY

### ISO DIN radio provision with pocket

1. Remove the metal DIN sleeve and trim ring from the aftermarket radio.
2. Secure the **ISO Brackets** to the radio using the screws supplied with the radio. (Figure A)
3. Slide the radio into the radio opening until the side clips engage. (Figure B)
4. Snap the **ISO trim plate** into the **radio housing**. (Figure B)
5. Snap the **pocket** into the **radio housing**. (Figure B)
6. Align the small legs on the bottom of the **radio housing** with the slots in the top of the climate control, then slide the climate control sideways to engage together. (Figure C)

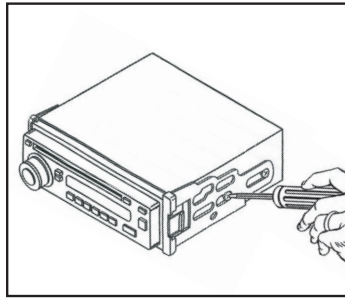

(Figure A)

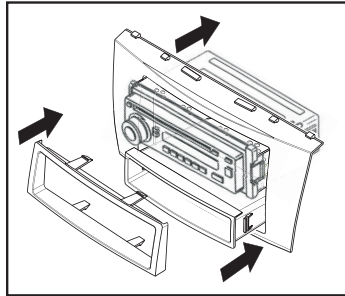

(Figure B)

7. Secure the **radio housing brackets** to the **radio housing** using the (4) #8 x 3/8 Phillips screws provided. (Figure D)
8. Secure the **radio housing brackets** to the climate control using the factory screws. (Figure D)
9. Secure the (2) clips removed in Dash Disassembly to the **radio housing brackets** using (4) # 8 x 3/8 Phillips screws provided. (Figure D)
10. Locate the factory wiring harness and antenna connector in the dash. Metra recommends using the proper mating adapter from Metra or AXXESS. Test the radio for proper operation.
11. Slide the radio assembly into the dash, then secure using the factory screws.
12. Reassemble the dash in reverse order of disassembly to complete the installation.

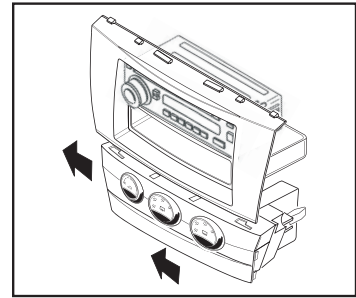

(Figure C)

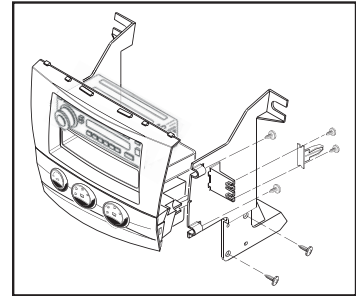

(Figure D)

## KIT ASSEMBLY

### ISO DDIN radio provision

1. Cut and remove center divider from **radio housing**. (Figure A)
2. Snap the **ISO DDIN brackets** to the inside edge of the **radio housing**. (Figure B)
3. Slide the radio into the bracket/radio housing assembly, then secure using screws supplied with the radio. (Figure C)
4. Snap the **ISO DDIN trim plate** into the housing/radio assembly. (Figure C)
5. Align the small legs on the bottom of the **radio housing** with the slots in the top of the climate control, then slide the climate control sideways to engage together. (Figure D)

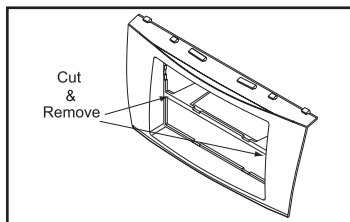

(Figure A)

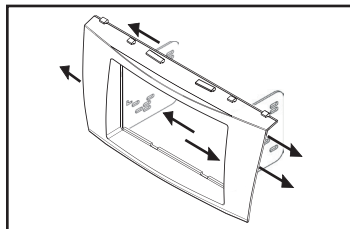

(Figure B)

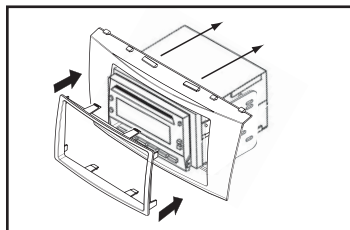

(Figure C)

6. Secure the **radio housing brackets** to the **radio housing** using the (4) #8 x 3/8 Phillips screws provided. (Figure E)
7. Secure the radio housing brackets to the climate control using the factory screws. (Figure E)
8. Secure the (2) clips removed in Dash Disassembly to the **radio housing brackets** using (4) # 8 x 3/8 Phillips screws provided. (Figure E)
9. Locate the factory wiring harness and antenna connector in the dash. Metra recommends using the proper mating adapter from Metra or AXXESS. Test the radio for proper operation.
10. Slide the radio assembly into the dash, then secure using the factory screws.
11. Reassemble the dash in reverse order of disassembly to complete the installation.

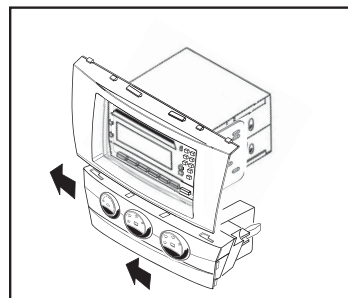

(Figure D)

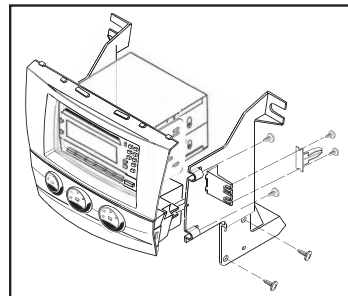

(Figure E)





**99-8218**  
INSTALLATION INSTRUCTIONS



If you are having difficulties with the installation of this product, contact our Tech Support line either by phone at **1-800-253-TECH**, or email at **techsupport@metra-autosound.com**. Before doing so, look over the instruction booklet a second time and ensure that the installation was performed exactly as the instruction booklet is stated. Have the vehicle apart and ready to perform troubleshooting steps before contacting Metra/Axxess Tech Support.



**KNOWLEDGE IS POWER**

Enhance your installation and fabrication skills by enrolling in the most recognized and respected mobile electronics school in our industry. Log onto [www.installerinstitute.com](http://www.installerinstitute.com) or call 800-354-6782 for more information and take steps toward a better tomorrow.



**Metra recommends MECP  
certified technicians**