



Installation instructions for part 99-8214

Toyota Tacoma 2005-2011 99-8214

KIT FEATURES

- DIN radio provision with pocket
- ISO DIN radio provision with pocket
- ISO DDIN radio provision
- **Painted and textured to match factory dash**
- **Available in: Black 99-8214TB or Gray 99-8214TG**
- **Both kits are factory "golf ball" textured**



KIT COMPONENTS

- A) Radio housing • B) Radio brackets • C) Radio trim panel • D) ISO brackets • E) ISO trim plate
- F) ISO DDIN trim plate • G) Clock/Hazard switch bracket • H) (4) #6 x 3/8" Phillips pan-head screws
- I) (4) #8 X 3/8" Phillips truss-head screws • J) (1) #10 x 3/4" Phillips pan-head screw • K) (4) Panel clips
- L) Plastic threaded insert

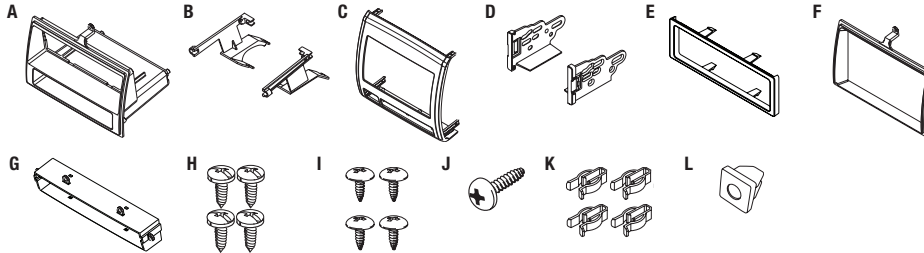

REV. 3/7/2017 INST99-8214

Table of Contents

Dash Disassembly	2
Kit Preparation	3
Kit Assembly	
– DIN radio provision with pocket	4
– ISO DIN radio provision with pocket	5
– ISO DDIN radio provision	6

WIRING & ANTENNA CONNECTIONS (sold separately)

Wiring Harness: 70-1761 • TYTO-01

Antenna Adapter: Not Required

Steering wheel control interface: ASWC-1

TOOLS REQUIRED

- Panel removal tool • Phillips screwdriver
- 10mm socket wrench

CAUTION! All accessories, switches, climate controls panels, and especially air bag indicator lights must be connected before cycling the ignition. Also, do not remove the factory radio with the key in the on position, or while the vehicle is running.

Dash Disassembly

1. Unclip, unplug and remove the climate control panel. (Figure A)
2. Remove the (4) 10mm screws securing the bottom of the radio/clock/hazard assembly. (Figure B)
3. Unclip, unplug, and remove the radio/clock/hazard assembly. (Figure C)

Continue to Kit Preparation

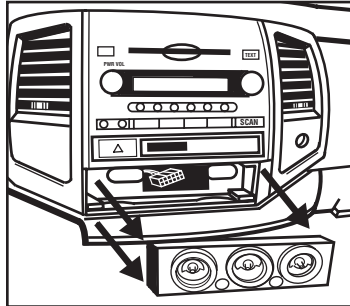

(Figure A)

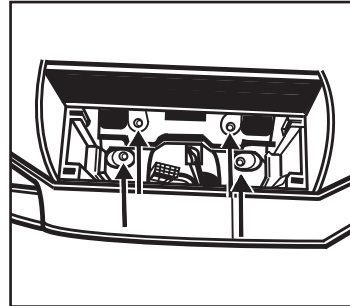

(Figure B)

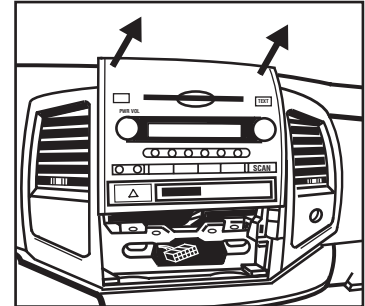

(Figure C)

Kit Preparation

1. Attach the *plastic threaded insert* into the sub-dash of the vehicle. (Figure A)

From the factory radio/clock/hazard assembly:

1. Unclip and remove the clock/hazard switch assembly. (Figure B)

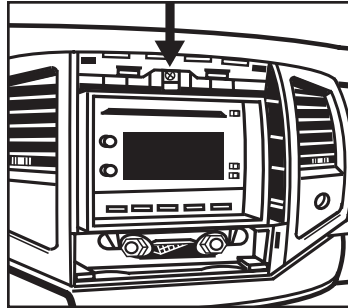

(Figure A)

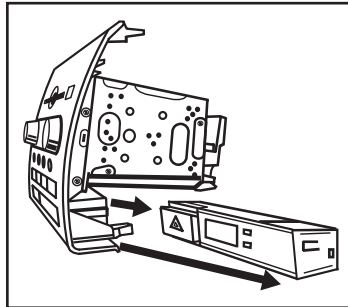

(Figure B)

To the 99-8214 radio housing:

1. Attach the *clock/hazard switch bracket* to the housing using the (4) #6 x 3/8" Phillips pan-head screws supplied. (Figure C)

WARNING: DO NOT OVERTIGHTEN THE SCREWS.

2. Clip the factory clock/hazard switch assembly into the bracket housing assembly. (Figure D)
3. Attach the (4) *panel clips* to the housing.

Continue to Kit Assembly

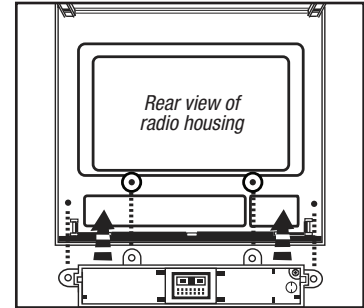

(Figure C)

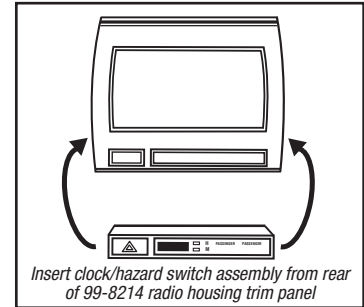

(Figure D)

Kit Assembly

DIN radio provision with pocket

1. Attach the corresponding *radio bracket* to the *radio housing* using the (4) #8 x 3/8" Phillips truss-head screws supplied. (Figure A)
2. Remove the metal DIN sleeve from the aftermarket radio.
3. Slide the sleeve into the *radio housing* and secure by bending the metal locking tabs down. (Figure B)
4. Slide the radio into the sleeve until it clicks in. (Figure C)
5. Locate the factory wiring harness and antenna connector in the dash. Metra recommends using the proper mating adapter from Metra or AXCESS. Test the radio for proper operation.
6. Secure the completed assembly into the dash using the factory screws at the bottom, and the (1) #10 x 3/4" pan-head screw at the top.
7. Reassemble the dash in reverse order of disassembly using the 99-8214 *radio trim panel*.

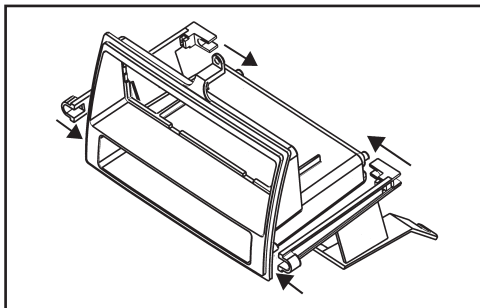

(Figure A)

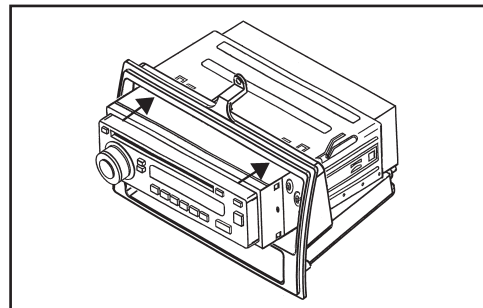

(Figure C)

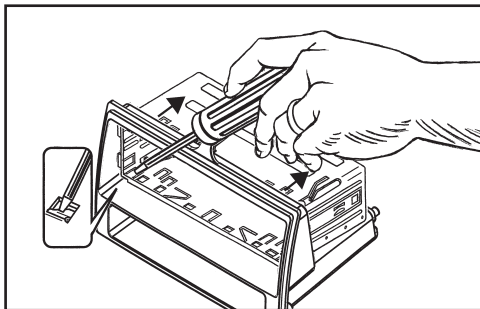

(Figure B)

Kit Assembly

ISO DIN radio provision with pocket

1. Attach the corresponding *radio bracket* to the *radio housing* using the (4) #8 x 3/8" Phillips truss-head screws supplied. (Figure A)
2. Remove the metal DIN sleeve and trim ring from the aftermarket radio.
3. Secure the *ISO brackets* to the radio with the screws supplied with the radio. (Figure B)
4. Slide the radio into the radio opening until the side clips engage. (Figure C)
5. Snap the *ISO trim plate* into the *radio housing*. (Figure C)
6. Locate the factory wiring harness and antenna connector in the dash. Metra recommends using the proper mating adapter from Metra or AXCESS. Test the radio for proper operation.
7. Secure the *radio housing* into the dash using the factory screws at the bottom, and the (1) #10 x 3/4" pan-head screw at the top.
8. Reassemble the dash in reverse order of disassembly using the 99-8214 *radio trim panel*.

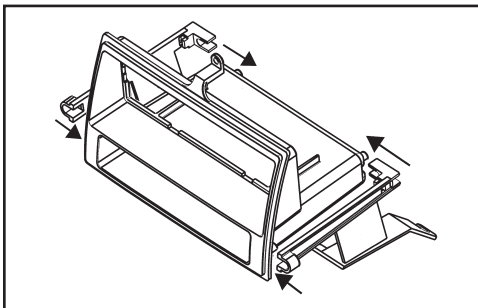

(Figure A)

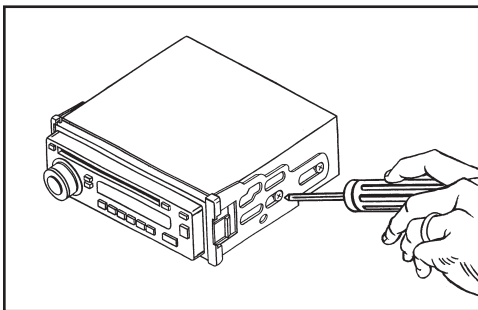

(Figure B)

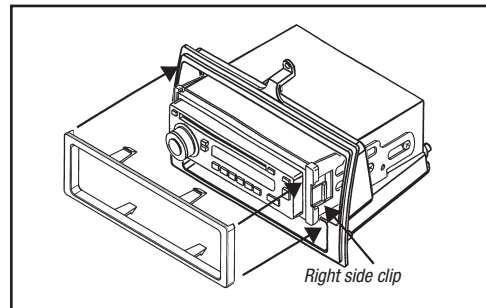

(Figure C)

Kit Assembly

ISO DDIN radio provision

1. Remove the metal radio brackets from the factory radio. (Figure A)
2. Attach the brackets to the radio using the screws supplied with the radio. (Figure B)
3. Locate the factory wiring harness and antenna connector in the dash. Metra recommends using the proper mating adapter from Metra or AXXESS. Test the radio for proper operation.
4. Secure the radio/bracket assembly into the dash using the factory screws at the bottom, and the (1) #10 x 3/4" pan-head screw at the top.
5. Reassemble the dash in reverse order of disassembly using the 99-8214 *radio trim panel*.

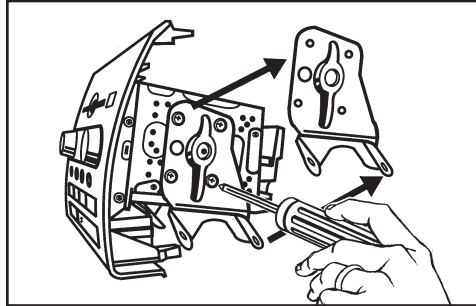

(Figure A)

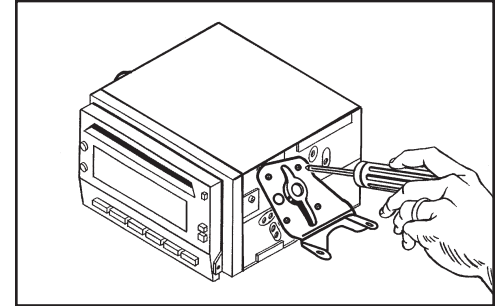

(Figure B)

Notes



Installation instructions for part 99-8214



IMPORTANT

If you are having difficulties with the installation of this product, please call our Tech Support line at **1-800-253-TECH**. Before doing so, look over the instructions a second time, and make sure the installation was performed exactly as the instructions are stated. Please have the vehicle apart and ready to perform troubleshooting steps before calling.



KNOWLEDGE IS POWER

Enhance your installation and fabrication skills by enrolling in the most recognized and respected mobile electronics school in our industry. Log onto www.installerinstitute.com or call 800-354-6782 for more information and take steps toward a better tomorrow.



**Metra recommends MECP
certified technicians**

REV. 3/7/2017 INST99-8214