



Lexus IS 250/350* (without NAV) 2006-2013

Lexus IS 250C/350C* (without NAV) 2006-2015

* U.S. models only

KIT FEATURES

- ISO DIN radio provision with pocket
- ISO DDIN radio provision
- Painted two-tone gray and black
- Touchscreen display for the climate control
- Passenger seatbelt and airbag indicator

Note: The kit will not retain the factory amplifier nor provide you with the following outputs for aftermarket units equipped with Navigation. Ex. VSS, Parking Brake and Reverse.

Important! When using either the **AX-AB-LX2** or **AX-AB-LX3** bypass harness, Factory amp must stay plugged into vehicle in order for your factory HVAC to work.

KIT COMPONENTS

- A) Radio trim panel with touchscreen display
- B) Radio brackets
- C) Pocket
- D) (8) #8 x 3/8" Phillips screws
- E) Axxess interface and harnesses (not shown)

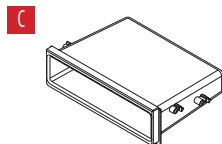
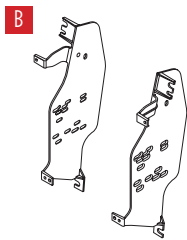
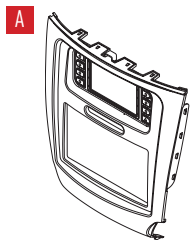

TABLE OF CONTENTS

Dash Disassembly	2
Kit Assembly	
–ISO DIN radio provision with pocket	3
–ISO DDIN radio provision.....	4
Final Assembly	9
Axxess Interface Installation.....	5-13

WIRING & ANTENNA CONNECTIONS

- Wiring Harness: Axxess touch screen interface and wiring harnesses included
- Antenna Adapter: Included with kit
- Amp Bypass Harness: Included with kit

TOOLS REQUIRED

- Panel removal tool
- Phillips screwdriver
- 10mm socket wrench

Attention! Let the vehicle sit with the key out of the ignition for a few minutes before removing the factory radio. When testing the aftermarket equipment, ensure that all factory equipment is connected before cycling the key to ignition.

DASH DISASSEMBLY

1. Unclip and remove the (2) small trim panels from the top of the center console next to the cigarette lighter pocket. (Figure A)
2. Rotate the a/c vents down so they are facing the floor, release the (4) tabs inside the top edge of the panel, then unclip and remove the a/c vents from the dash. (Figure B, C)

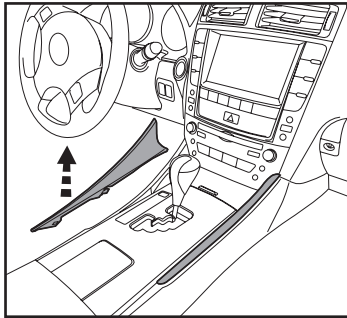

(Figure A)

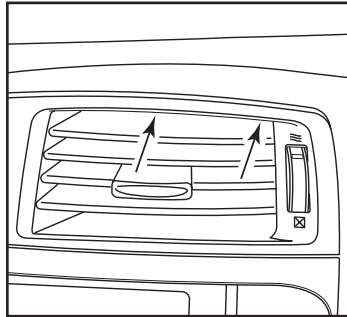

(Figure B)

3. Remove (4) 10mm bolts securing the factory radio/climate control assembly, then unplug all harnesses and remove the assembly. (Figure D)
4. Behind the radio/climate control panel is a module. This module will need to be relocated to allow room for the aftermarket radio.

Continue to Kit Preparation

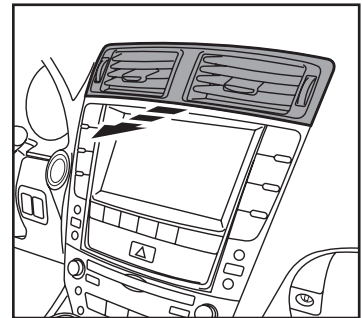

(Figure C)

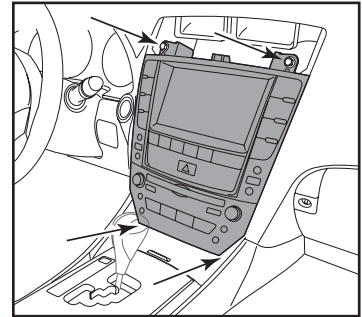

(Figure D)

KIT ASSEMBLY

ISO DIN radio provision with pocket

1. Attach the *radio brackets* to the *radio trim panel with touchscreen* using the (4) #8 x 3/8" *Phillips screws* supplied. (Figure A)
2. Attach the *pocket* to the *radio brackets* using the (4) #8 x 3/8" *Phillips screws* supplied. (Figure B)
3. Remove the metal DIN sleeve and trim ring from the aftermarket radio.
4. Slide the radio into the radio bracket assembly and secure with screws supplied with the radio. (Figure C)

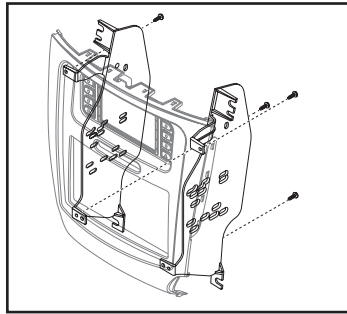

(Figure A)

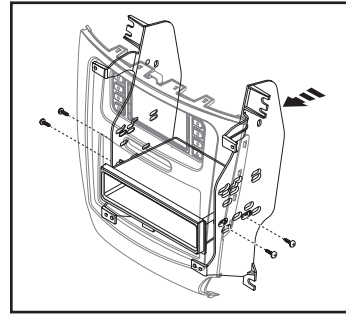

(Figure B)

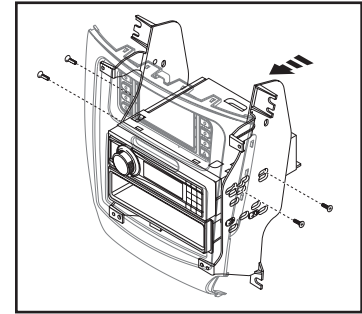

(Figure C)

Continue to *Axxess Interface Installation*

KIT ASSEMBLY

ISO DDIN radio provision

1. Attach the *radio brackets* to the *radio trim panel with touchscreen* using the (4) #8 x 3/8" *Phillips screws* supplied. (Figure A)
2. Attach the *radio brackets* to the *radio* using the screws supplied with the radio. (Figure B)

Continue to *Axxess Interface Installation*

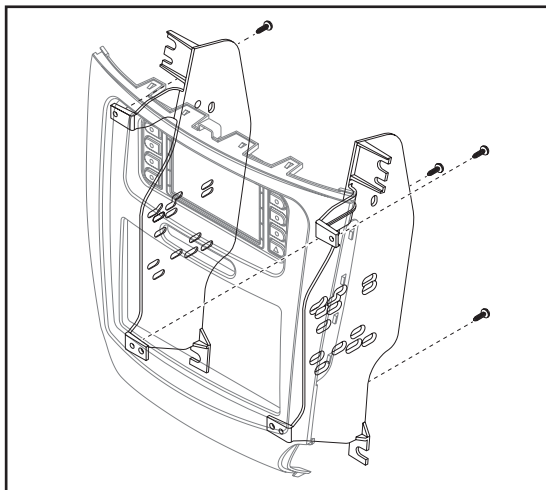

(Figure A)

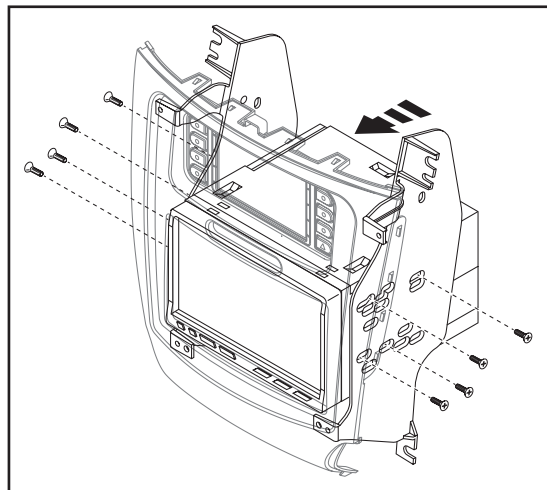

(Figure B)

AXXESS INTERFACE INSTALLATION

INTERFACE FEATURES

- Provides accessory power (12-volt 10-amp)
- Retains R.A.P. (retained accessory power)
- Provides NAV outputs (parking brake, reverse, speed sense)
- Retains audio controls on the steering wheel
- Retains the passenger airbag and seatbelt indicator
- Allows an aftermarket backup camera to be viewed on the 99-8163 display screen
- Retains the factory AUX-IN jack
- Micro-B USB updatable

INTERFACE COMPONENTS

- Axxess interface (built into the touchscreen display)
- 8163 harness
- 16-pin harness with stripped leads
- 4-pin harness with yellow RCA jacks
- Airbag-indicator/hazard/passenger-seatbelt harness
- Female 3.5mm connector with stripped leads
- AX-AB-LX1, AX-AB-LX2 and AX-AB-LX3 amplifier bypass harness (1 of each)

TABLE OF CONTENTS

Connections	6-7
Installation	8
Programming	9
Final assembly	9
Touchscreen display operation	10-11
Steering wheel control settings	12-13

TOOLS REQUIRED

- Crimping tool and connectors, or solder gun, solder, and heat shrink
- Tape • Wire cutter • Zip ties

CONNECTIONS

From the 16-pin harness with stripped leads to the aftermarket radio:

- Connect the **Red** wire to the accessory wire.

Note: There will also be an accessory wire from the 8163 harness to connect as well.

- Tape off and disregard the following (14) wires, they will not be used in this application:
Blue/White, Brown, Gray, Gray/Black, Green, Green/Black, Orange/White, Purple, Purple/Black, White, White/Black, Blue/Pink, Green/Purple, Light Green

From the 8163 harness to the aftermarket radio:

- Connect the **Black** wire to the ground wire.
- Connect the **Yellow** wire to the battery wire.
- Connect the **Blue** wire to the power antenna wire.
- Connect the **Blue/White** wire to the accessory wire.
- Connect the **Red** and **White** RCA jacks to the audio AUX-IN jacks from the aftermarket radio.
- Tape off and disregard the following (4) wires, they will not be used in this application:
White, White/Black, Gray, Gray/Black
- Use the appropriate amplifier bypass included with the kit to connect to the speakers, following the instructions included with the amplifier bypass. Take note that there are multiple speakers in the vehicle with varying impedance. An external amplifier(s) and either active or passive crossovers will be required (not provided).

Continued on the next page

3.5mm jack steering wheel control retention:

The 3.5mm jack is to be used to retain audio controls on the steering wheel control.

- **For the radios listed below:** Connect the *female 3.5mm connector with stripped leads* to the male 3.5mm SWC jack from the *8163 harness*. Any remaining wires tape off and disregard:
 - **Eclipse:** Connect the steering wheel control wire, normally **Brown**, to the **Brown/White** wire of the connector. Then connect the remaining steering wheel control wire, normally **Brown/White**, to the **Brown** wire of the connector.
 - **Metra OE:** Connect the steering wheel control Key 1 wire (**Gray**) to the **Brown** wire.
 - **Kenwood or select JVC with a steering wheel control wire:** Connect the **Blue/Yellow** wire to the **Brown** wire.

Note: If the **Kenwood** radio auto detects as a **JVC**, manually set the radio type to **Kenwood**. Refer to the **Select Radio** screen.
 - **XITE:** Connect the steering wheel control SWC-2 wire from the radio to the **Brown** wire.
 - **Parrot Asteroid Smart or Tablet:** Connect the 3.5mm jack into the **AX-SWC-PARROT** (sold separately), and then connect the 4-pin connector from the **AX-SWC-PARROT** into the radio.

Note: The radio must be updated to rev. 2.1.4 or higher software.

- **Universal “2 or 3 wire” radio:** Connect the steering wheel control wire, referred to as Key-A or SWC-1, to the **Brown** wire from the connector. Then connect the remaining steering wheel control wire, referred to as Key-B or SWC-2, to the **Brown/White** wire from the connector. If the radio comes with a third wire for ground, disregard this wire.

Note: After the interface has been programmed to the vehicle, refer to the manual provided with the radio for assigning the SWC buttons. Contact the radio Manufacturer for more information.

- **For all other radios:** Connect the 3.5mm jack into the port on the radio designated for an external steering wheel control interface. Refer to the manual provided with the radio if in doubt as to where the 3.5mm jack goes to.

4-pin harness with yellow RCA jacks:

- If an aftermarket backup camera is desired to be displayed onto the touchscreen display, connect the **Yellow** RCA jack labeled “Rearview camera”, to the **Yellow** RCA jack.
- Disregard the **Yellow** RCA jack labeled “AUX video”, it will not be used in this application.

INSTALLATION

It is highly advisable to read the following steps beforehand, to ensure a clear understanding of what is to be expected. The following steps must be done in the order that they are numbered.

With the vehicle completely off:

1. Connect the *16-pin harness with stripped leads* into port “B” in the touchscreen display.
2. Connect the *8163 harness* to the wiring harnesses in the vehicle. Then insert the *8163 harness* into port “A” in the touchscreen display. But do not install this harness until exactly before step 1 from the **Programming** section. This is a timed process.
3. Connect the *4-pin harness with yellow RCA jacks* into port “C” in the touchscreen display.
4. Connect the *airbag-indicator/hazard/passenger-seatbelt harness*:
 - a. Connect the harness to the 12-pin and 14-pin harnesses in the vehicle.
 - b. Connect the harness into the *airbag/seatbelt indicator*.
 - c. Connect the harness into port “D” in the touchscreen display.
5. Disregard port “E”, it will not be used in this application.
6. Port “F” is an update port for future firmware upgrades.
7. Locate the factory antenna connector in the dash and complete all necessary connections to the radio. Use the *antenna adapter* provided to adapt the factory antenna connector to the aftermarket radio.

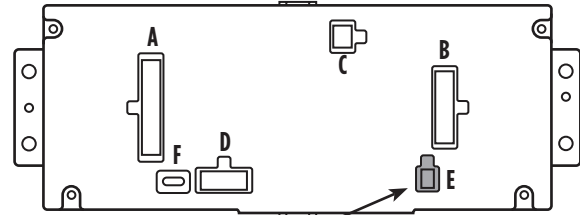

Note: DO NOT CONNECT!

PROGRAMMING

Attention! If the interface loses power for any reason, the following steps will need to be performed again.

1. Refer to step 2 from the “Installation” section.
2. Start the vehicle.
3. Program the kit:
 - a. Once the touchscreen display loads up, select the vehicle type; “Lexus IS”.
 - b. Wait until the radio comes on, and the touchscreen display shows “SWC Configured**”. This process may take up to 3 minutes.

Note: If the touchscreen display does not load up, or the radio doesn’t come on within 3 minutes, and/or the touchscreen display does not show “SWC Configured**”, turn the vehicle off and disconnect the 8163 harnesses from port “A” in the touchscreen display. Check all the connections, reconnect the harness into the touchscreen display, and then try again.

4. Cycle the key off, then back on. If the driver’s door is closed, open and close the door.
5. Test all functions of the installation for proper operation, before reassembling the dash.

FINAL ASSEMBLY

1. Secure the completed assembly into the dash using the factory hardware.
2. Reassemble the dash in reverse order of disassembly to complete the installation.

TOUCHSCREEN DISPLAY OPERATION

Climate Control Screen

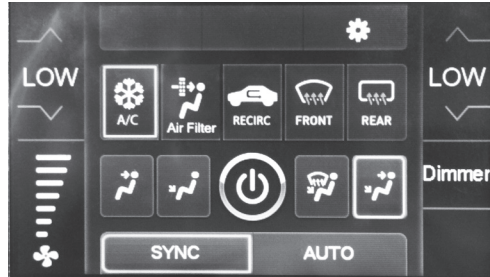

- This is the climate control screen which will be displayed on the touchscreen display. This is considered the main screen.
- The upper right tab with the gear icon will take you to the **Configuration Settings** screen.
- The **Dimmer** button will control the illumination intensity: LOW/HIGH
- The climate controls will function in the same manner that they did with the factory climate controls.

Continued on the next page

TOUCHSCREEN DISPLAY OPERATION *(CONT.)*

Configuration Settings screen

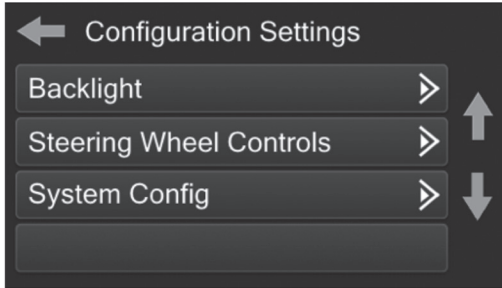

- **Backlight**
 - Four slide bars control the color of the buttons and the back-light intensity: Red / Green / Blue / Backlight
- **Steering Wheel Controls**
 - Remap Buttons – For remapping the steering wheel control buttons
 - Dual Assign – For dual assigning the steering wheel control buttons (long button press)
 - Select Radio – For auto detecting the radio, or changing the radio type
- **System Configuration**
 - About - Information regarding the software in the kit
 - Digital Amp Gain - For adjusting the output gain to the amplifier

STEERING WHEEL CONTROL SETTINGS

Remap Buttons



- The interface has the ability to change the button assignment for the steering wheel control audio buttons, except **Volume-Up** and **Volume-Down**. Follow the prompts on the touchscreen display to remap the steering wheel control audio button(s) to your liking.

Note: The aftermarket radio may not have all of these commands. Please refer to the manual provided with the radio, or contact the radio manufacturer, for specific commands recognized by that particular radio.

Dual Assign

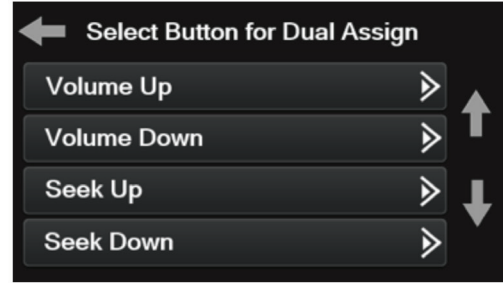

- The interface has the capability to assign two functions to a single button, except **Volume-Up** and **Volume-Down**. Follow the prompts on the touchscreen display to program the button(s) to your liking.

Note: **Seek-Up** and **Seek-Down** come programmed as **Preset-Up** and **Preset-Down** for a long button press.

STEERING WHEEL CONTROL SETTINGS (CONT.)

Select Radio



- To show which brand radio is “auto detected” to the interface, press the **Autodetect** button. The radio detected will have a filled in circle. If the incorrect radio is shown, select the proper radio.
- Following is a list of radio manufacturers that the interface presently acknowledges. Others may be added at a later date. Universal “2 or 3 wire” radios can show up as any of these radio manufacturers.

Eclipse (Type 1) †	Pioneer/Jensen	Clarion (Type 2) †	Parrot **
Kenwood ‡	Alpine *	Metra OE	XITE
Clarion (Type 1) †	Visteon	Eclipse (Type 2) †	Phillips
Sony / Dual	Valor	LG	JBL
JVC			

*** Note:** If the interface shows an **Alpine** radio, and you do not have an **Alpine** radio, that means the interface does not detect a radio connected it, i.e., an open connection. Verify that the 3.5mm jack is connected to the correct steering wheel jack/wire in the radio.

**** Note:** The **AX-SWC-PARROT** is required (sold separately). Also, the Parrot radio must be updated to rev. 2.1.4 or higher through www.parrot.com.

† Note: If you have a **Clarion** radio and the steering wheel controls do not work, change the radio type to the other **Clarion** radio type; same for **Eclipse**.

‡ Note: If you have a **Kenwood** radio and the touchscreen display shows a **JVC** radio, change the radio type to **Kenwood**.







99-8163
INSTALLATION INSTRUCTIONS



If you are having difficulties with the installation of this product, contact our Tech Support line either by phone at **386-257-1187**, or email at **techsupport@metra-autosound.com**. Before doing so, look over the instruction booklet a second time and ensure that the installation was performed exactly as the instruction booklet is stated. Have the vehicle apart and ready to perform troubleshooting steps before contacting Metra/Axxess Tech Support.



KNOWLEDGE IS POWER

Enhance your installation and fabrication skills by enrolling in the most recognized and respected mobile electronics school in our industry. Log onto www.installerinstitute.com or call 800-354-6782 for more information and take steps toward a better tomorrow.



Metra recommends MECP certified technicians